

2	7		8			10					11				12			13	
	Product Code		a	b	c	d	e	Dimensions								Inertia(kg·m <sup>2</sup> )*2	Maximum Motor Torque (N·m)*3		
								f	g	h		j	k	l	m			n	
RU100-20GU-BV	RU100-20GU-BV-A	19	90	110	7	33.3	55~60	145	4×M8 15DP.	320	90	135	34	48	6.96×10 <sup>-4</sup>	53.33			
RU100-20GU-BW	RU100-20GU-BW-A	19	90	110	7	33.3	55~60	145	4×M8 15DP.	320	90	135	34	48	6.96×10 <sup>-4</sup>	53.33			
RU100-20GU-BR	RU100-20GU-BR-A	19	90	110	7	33.3	55~60	145	4×M8 15DP.	320	90	135	34	48	6.96×10 <sup>-4</sup>	53.33			
RU100-20GU-BS	RU100-20GU-BS-A	19	90	110	7	33.3	55~60	145	4×M8 15DP.	320	90	135	34	48	6.96×10 <sup>-4</sup>	53.33			
RU100-20GU-CV	RU100-20GU-CV-A	22	90	110	7	33.3	55~60	145	4×M8 15DP.	320	90	135	34	48	6.96×10 <sup>-4</sup>	53.33			
RU100-20GU-CW	RU100-20GU-CW-A	22	90	110	7	33.3	55~60	145	4×M8 15DP.	320	90	135	34	48	6.96×10 <sup>-4</sup>	53.33			
RU100-20GU-CR	RU100-20GU-CR-A	22	90	110	7	33.3	55~60	145	4×M8 15DP.	320	90	135	34	48	6.96×10 <sup>-4</sup>	53.33			
RU100-20GU-CS	RU100-20GU-CS-A	22	90	110	7	33.3	55~60	145	4×M8 15DP.	320	90	135	34	48	6.96×10 <sup>-4</sup>	53.33			
RU100-20GU-DV	RU100-20GU-DV-A	24	90	110	7	33.3	55~60	145	4×M8 15DP.	320	90	135	34	48	6.96×10 <sup>-4</sup>	53.33			
RU100-20GU-DW	RU100-20GU-DW-A	24	90	110	7	33.3	55~60	145	4×M8 15DP.	320	90	135	34	48	6.96×10 <sup>-4</sup>	53.33			
RU100-20GU-DR	RU100-20GU-DR-A	24	90	110	7	33.3	55~60	145	4×M8 15DP.	320	90	135	34	48	6.96×10 <sup>-4</sup>	53.33			
RU100-20GU-DS	RU100-20GU-DS-A	24	90	110	7	33.3	55~60	145	4×M8 15DP.	320	90	135	34	48	6.96×10 <sup>-4</sup>	53.33			

Notes.

\*1 モータ軸締結用アクセスホールは製品コードに該当する箇所に2箇所のみ加工  
Only two access holes for assembling motor is specified by attachment code to be machined.

\*2 慣性モーメント(イナーシャ)はモータ軸換算値とする。(モータイナーシャは含まない)。  
The moment of inertia is on motor shaft except for motor of inertia.

\*3 サーボモータは上表最大モータトルク以下で使用のこと。  
Do not operate the servo motor more than specified maximum motor torque which is on above table.

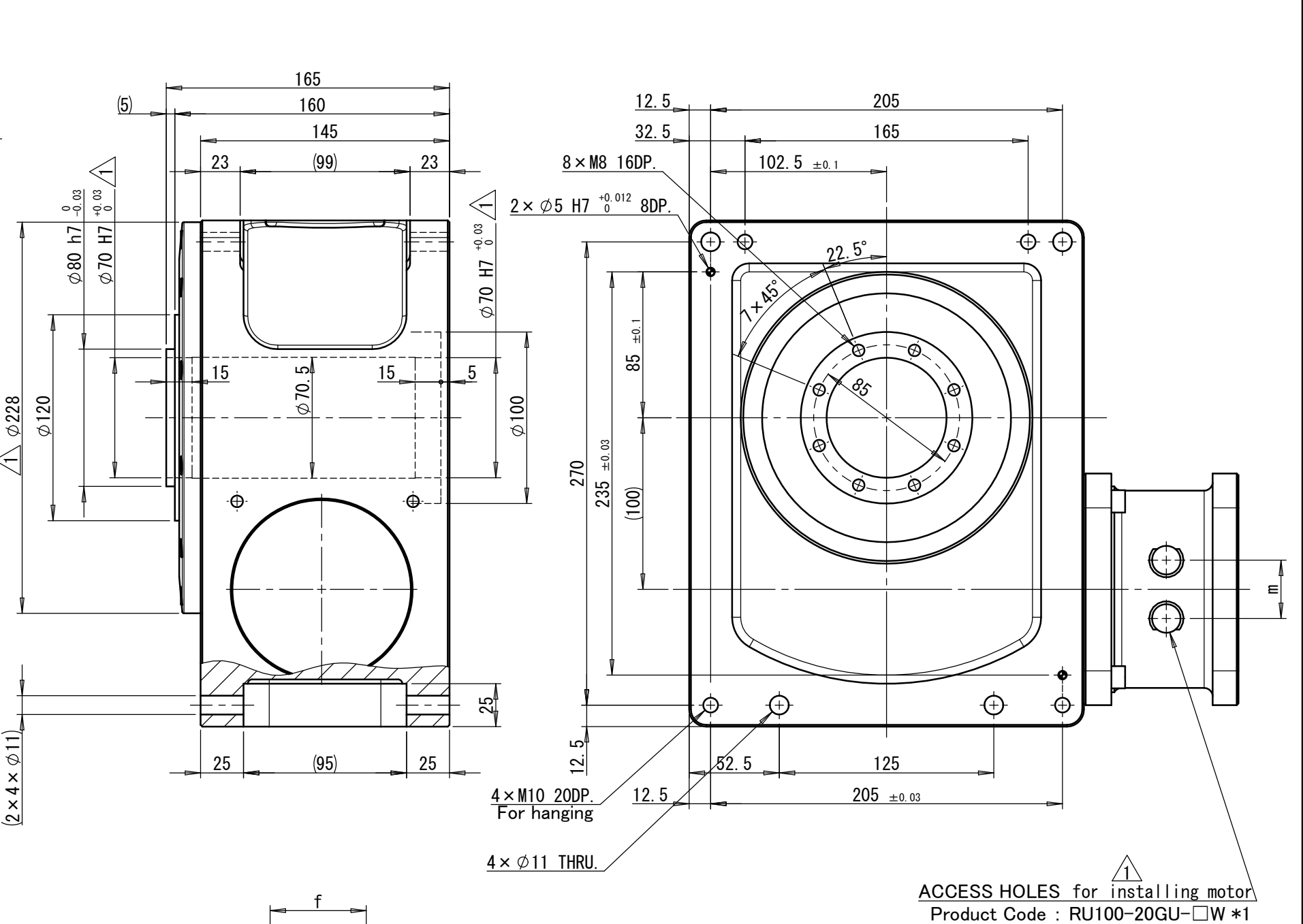
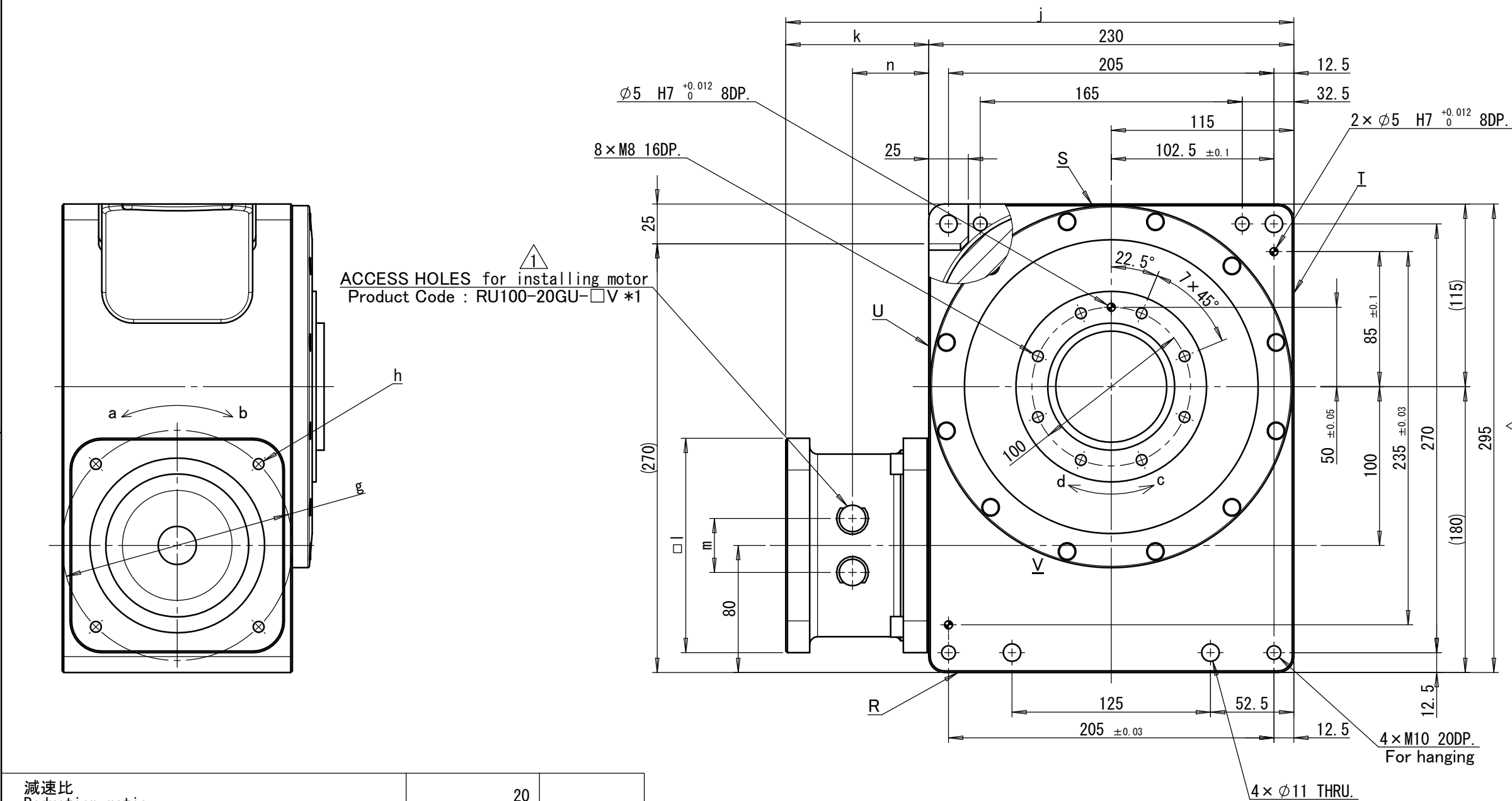

減速比 Reduction ratio	20
静定格出力トルク Static output torque rating	1,000 $\text{N} \cdot \text{m}$
動定格出力トルク Dynamic output torque rating	△ 上図参照 $\text{N} \cdot \text{m}$
最高出力回転数 Maximum output speed △	100 $\text{min}^{-1}$
定格出力回転数 Nominal output speed △	30 $\text{min}^{-1}$
位置決め精度 Positioning accuracy	40 arcsec以下 △
繰返し精度 Repeatability	±5 arcsec以下 △
出力軸アキシャル振れ(V面) Axial runout of output surface (V)	10 $\mu\text{m}$ 以下 △
出力軸ラジアル振れ(V面) Radial runout of output outer diameter (V)	10 $\mu\text{m}$ 以下 △
出力軸許容アキシャル荷重 Maximum axial load of output	21,000 $\text{N}$
出力軸許容ラジアル荷重 Maximum radial load of output	18,000 $\text{N}$
出力軸許容モーメント荷重 Maximum moment load of output	1,700 $\text{N} \cdot \text{m}$
入出力軸回転方向 Direction of input-output shafts rotation	a-d, b-c
製品概略質量 Weight △	50 $\text{kg}$

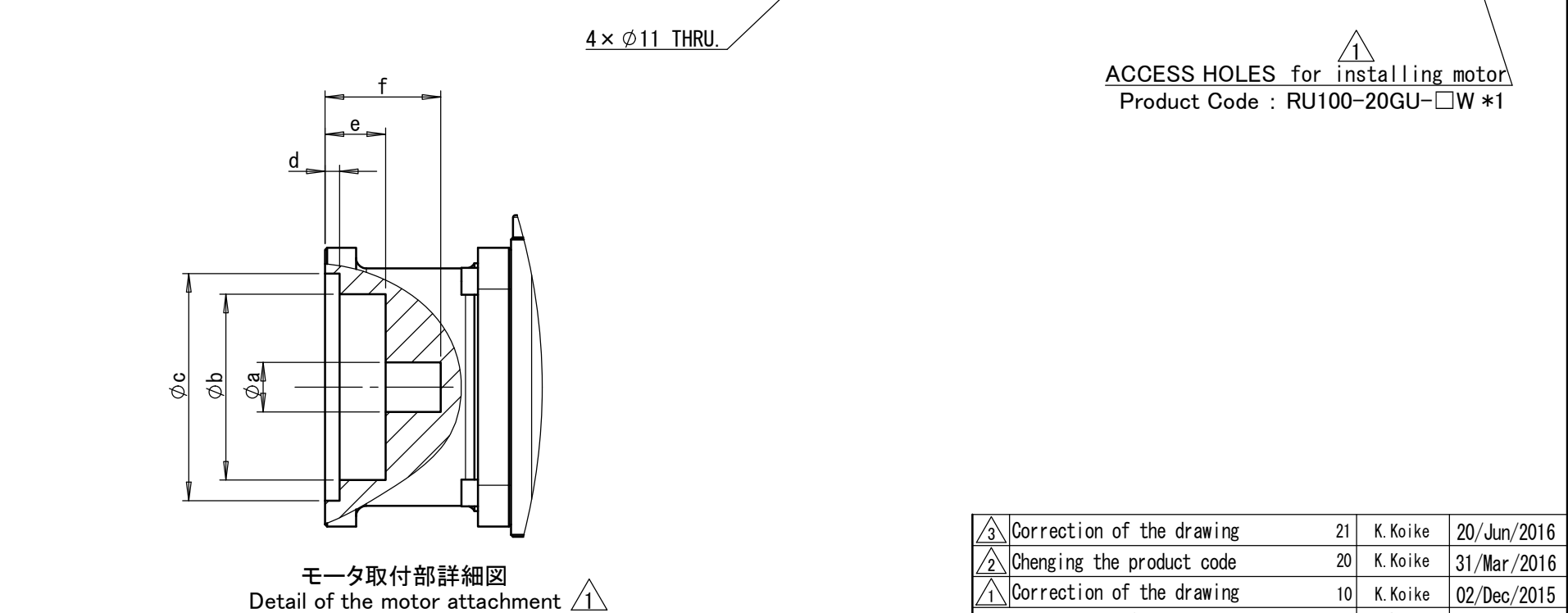
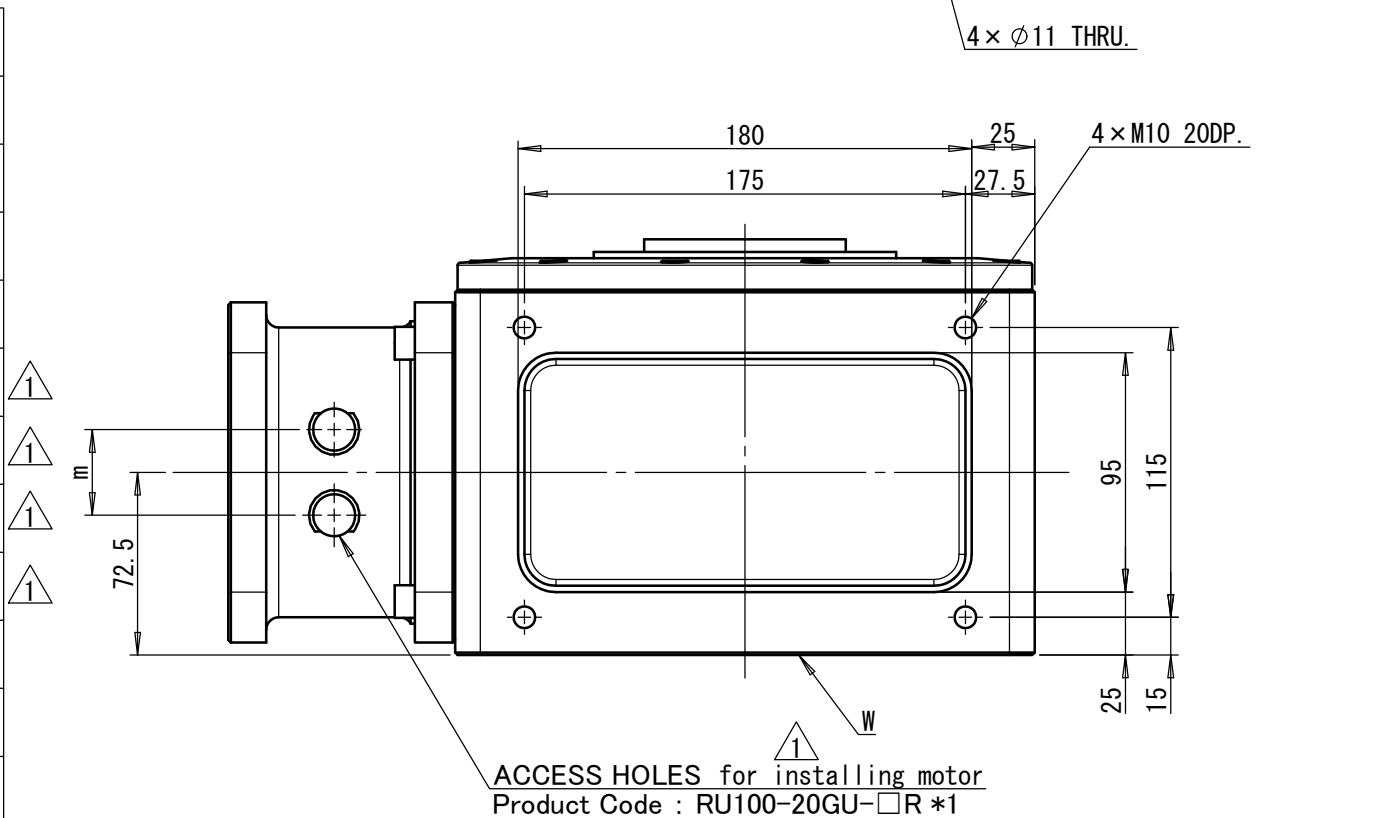

Scale	1:3	Date	03/Apr. /2014
Designer	K. Katsumata	Checker	K. Iida
Draftsman	Y. Tomiyama	Assent	K. Iida

Correction of the drawing	21	K. Koike	20/Jun/2016
Chenging the product code	20	K. Koike	31/Mar/2016
Correction of the drawing	10	K. Koike	02/Dec/2015
Correction		Sign	Date
Model	<b>RollerDrive</b> RU100-20GU		<b>CERTIFIED PRINT</b>
Draw.No.	RU1007Z0099-021		